

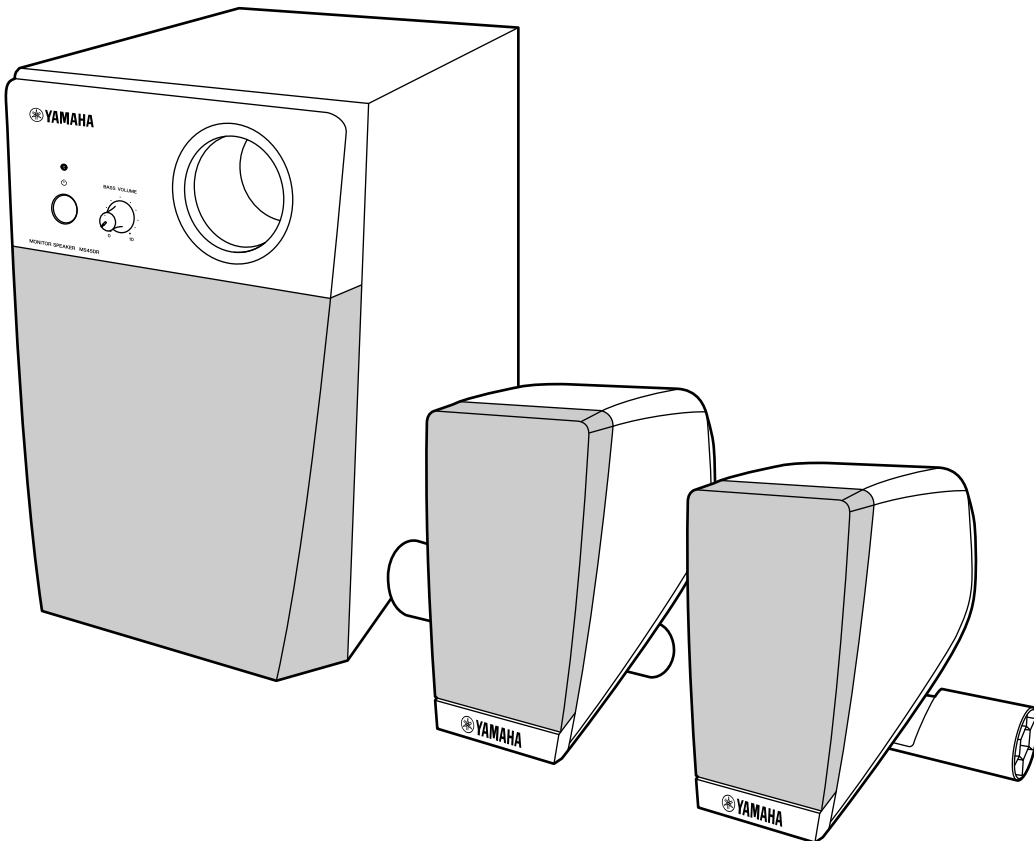

MONITOR SPEAKER  
MONITOR SPEAKER  
SYSTÈME D'ÉCOUTE  
SISTEMA DE MONIÇÃO  
监听音箱  
모니터 스피커  
モニタースピーカー

# MS45DR

Owner's Manual  
Bedienungsanleitung  
Mode d'emploi  
Manual do Proprietário  
使用说明书  
사용설명서  
取扱説明書



English

Deutsch

Français

Português

中文

한국어

日本語

EN  
DE  
FR  
PT  
ZH  
KO  
JA

# SPECIAL MESSAGE SECTION

**PRODUCT SAFETY MARKINGS:** Yamaha electronic products may have either labels similar to the graphics shown below or molded/stamped facsimiles of these graphics on the enclosure. The explanation of these graphics appears on this page. Please observe all cautions indicated on this page and those indicated in the safety instruction section.

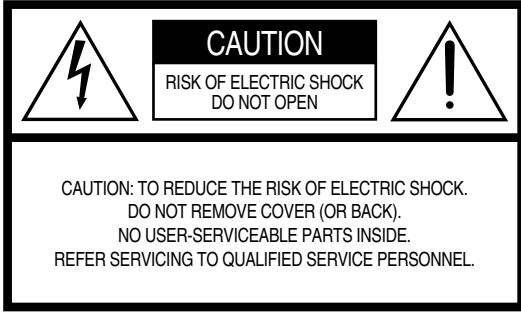

The exclamation point within the equilateral triangle is intended to alert the user to the presence of important operating and maintenance (servicing) instructions in the literature accompanying the product.

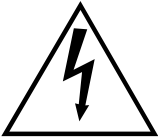

The lightning flash with arrowhead symbol, within the equilateral triangle, is intended to alert the user to the presence of uninsulated “dangerous voltage” within the product’s enclosure that may be of sufficient magnitude to constitute a risk of electrical shock.

**IMPORTANT NOTICE:** All Yamaha electronic products are tested and approved by an independent safety testing laboratory in order that you may be sure that when it is properly installed and used in its normal and customary manner, all foreseeable risks have been eliminated. **DO NOT** modify this unit or commission others to do so unless specifically authorized by Yamaha. Product performance and/or safety standards may be diminished. Claims filed under the expressed warranty may be denied if the unit is/has been modified. Implied warranties may also be affected.

**SPECIFICATIONS SUBJECT TO CHANGE:** The information contained in this manual is believed to be correct at the time of printing. However, Yamaha reserves the right to change or modify any of the specifications without notice or obligation to update existing units.

**ENVIRONMENTAL ISSUES:** Yamaha strives to produce products that are both user safe and environmentally friendly. We sincerely believe that our products and the production methods used to produce them, meet these goals. In keeping with both the letter and the spirit of the law, we want you to be aware of the following:

**Battery Notice:** This product MAY contain a small non-rechargeable battery which (if applicable) is soldered in place. The average life span of this type of battery is approximately five years. When replacement becomes necessary, contact a qualified service representative to perform the replacement.

**Warning:** Do not attempt to recharge, disassemble, or incinerate this type of battery. Keep all batteries away from children. Dispose of used batteries promptly and as regulated by applicable laws. Note: In some areas, the servicer is required by law to return the defective parts. However, you do have the option of having the servicer dispose of these parts for you.

**Disposal Notice:** Should this product become damaged beyond repair, or for some reason its useful life is considered to be at an end, please observe all local, state, and federal regulations that relate to the disposal of products that contain lead, batteries, plastics, etc.

**NOTICE:** Service charges incurred due to lack of knowledge relating to how a function or effect works (when the unit is operating as designed) are not covered by the manufacturer’s warranty, and are therefore the owners responsibility. Please study this manual carefully and consult your dealer before requesting service.

**NAME PLATE LOCATION:** The graphic below indicates the location of the name plate. The model number, serial number, power requirements, etc., are located on this plate. You should record the model number, serial number, and the date of purchase in the spaces provided below and retain this manual as a permanent record of your purchase.

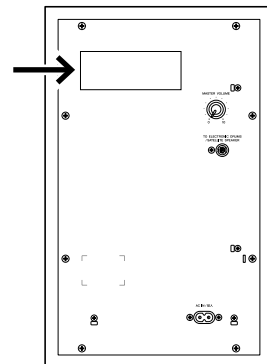

**Model** \_\_\_\_\_

**Serial No.** \_\_\_\_\_

**Purchase Date** \_\_\_\_\_

## FCC INFORMATION (U.S.A.)

### 1. IMPORTANT NOTICE: DO NOT MODIFY THIS UNIT!

This product, when installed as indicated in the instructions contained in this manual, meets FCC requirements. Modifications not expressly approved by Yamaha may void your authority, granted by the FCC, to use the product.

**2. IMPORTANT:** When connecting this product to accessories and/or another product use only high quality shielded cables. Cable/s supplied with this product **MUST** be used. Follow all installation instructions. Failure to follow instructions could void your FCC authorization to use this product in the USA.

**3. NOTE:** This product has been tested and found to comply with the requirements listed in FCC Regulations, Part 15 for Class "B" digital devices. Compliance with these requirements provides a reasonable level of assurance that your use of this product in a residential environment will not result in harmful interference with other electronic devices. This equipment generates/uses radio frequencies and, if not installed and used according to the instructions found in the users manual, may cause interference harmful to the operation of other electronic devices. Compliance with FCC regulations does not guarantee that interference will not

occur in all installations. If this product is found to be the source of interference, which can be determined by turning the unit "OFF" and "ON," please try to eliminate the problem by using one of the following measures:

Relocate either this product or the device that is being affected by the interference.

Utilize power outlets that are on different branch (circuit breaker or fuse) circuits or install AC line filter/s.

In the case of radio or TV interference, relocate/reorient the antenna. If the antenna lead-in is 300 ohm ribbon lead, change the lead-in to co-axial type cable.

If these corrective measures do not produce satisfactory results, please contact the local retailer authorized to distribute this type of product. If you can not locate the appropriate retailer, please contact Yamaha Corporation of America, Electronic Service Division, 6600 Orangethorpe Ave, Buena Park, CA90620

The above statements apply **ONLY** to those products distributed by Yamaha Corporation of America or its subsidiaries.

\* This applies only to products distributed by Yamaha Corporation of America.

(class B)

### COMPLIANCE INFORMATION STATEMENT (Supplier's declaration of conformity procedure)

Responsible Party : Yamaha Corporation of America  
Address : 6600 Orangethorpe Ave., Buena Park, Calif. 90620  
Telephone : 714-522-9011  
Type of Equipment : MONITOR SPEAKER  
Model Name : MS45DR

This device complies with Part 15 of the FCC Rules.

Operation is subject to the following two conditions:

- 1) this device may not cause harmful interference, and
- 2) this device must accept any interference received including interference that may cause undesired operation.

\* This applies only to products distributed by Yamaha Corporation of America.

(FCC SDoC)

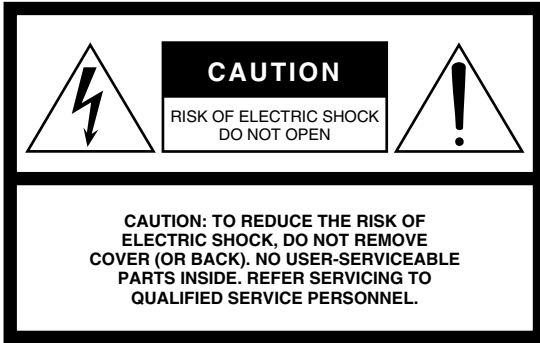

The above warning is located on the rear of the unit.

## Explanation of Graphical Symbols

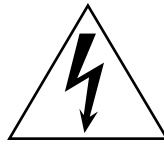

The lightning flash with arrowhead symbol within an equilateral triangle is intended to alert the user to the presence of uninsulated “dangerous voltage” within the product’s enclosure that may be of sufficient magnitude to constitute a risk of electric shock to persons.



The exclamation point within an equilateral triangle is intended to alert the user to the presence of important operating and maintenance (servicing) instructions in the literature accompanying the product.

# IMPORTANT SAFETY INSTRUCTIONS

- 1 Read these instructions.
- 2 Keep these instructions.
- 3 Heed all warnings.
- 4 Follow all instructions.
- 5 Do not use this apparatus near water.
- 6 Clean only with dry cloth.
- 7 Do not block any ventilation openings. Install in accordance with the manufacturer’s instructions.
- 8 Do not install near any heat sources such as radiators, heat registers, stoves, or other apparatus (including amplifiers) that produce heat.
- 9 Do not defeat the safety purpose of the polarized or grounding-type plug. A polarized plug has two blades with one wider than the other. A grounding type plug has two blades and a third grounding prong. The wide blade or the third prong are provided for your safety. If the provided plug does not fit into your outlet, consult an electrician for replacement of the obsolete outlet.
- 10 Protect the power cord from being walked on or pinched particularly at plugs, convenience receptacles, and the point where they exit from the apparatus.
- 11 Only use attachments/accessories specified by the manufacturer.
- 12 Use only with the cart, stand, tripod, bracket, or table specified by the manufacturer, or sold with the apparatus. When a cart is used, use caution when moving the cart/apparatus combination to avoid injury from tip-over.
- 13 Unplug this apparatus during lightning storms or when unused for long periods of time.
- 14 Refer all servicing to qualified service personnel. Servicing is required when the apparatus has been damaged in any way, such as power-supply cord or plug is damaged, liquid has been spilled or objects have fallen into the apparatus, the apparatus has been exposed to rain or moisture, does not operate normally, or has been dropped.



### WARNING

TO REDUCE THE RISK OF FIRE OR ELECTRIC SHOCK, DO NOT EXPOSE THIS APPARATUS TO RAIN OR MOISTURE.

(UL60065\_03)



L'avertissement ci-dessus se trouve à l'arrière de l'instrument.

## Explication des symboles graphiques

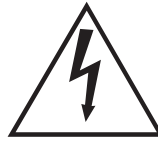

L'éclair avec une flèche à l'intérieur d'un triangle équilatéral est destiné à attirer l'attention de l'utilisateur sur la présence d'une « tension dangereuse » non isolée à l'intérieur de l'appareil, pouvant être suffisamment élevée pour constituer un risque d'électrocution.



Le point d'exclamation à l'intérieur d'un triangle équilatéral est destiné à attirer l'attention de l'utilisateur sur la présence d'instructions importantes sur l'emploi ou la maintenance (réparation) de l'appareil dans la documentation fournie.

# CONSIGNES DE SÉCURITÉ À LIRE ATTENTIVEMENT

- 1 Lisez les instructions ci-après.
- 2 Conservez ces instructions.
- 3 Tenez compte des avertissements.
- 4 Suivez toutes les instructions.
- 5 N'utilisez pas cet instrument dans un milieu humide.
- 6 Employez uniquement un chiffon sec pour nettoyer l'instrument.
- 7 N'obstruez pas les ouvertures prévues pour la ventilation. Installez l'instrument conformément aux instructions du fabricant.
- 8 N'installez pas l'instrument près d'une source de chaleur, notamment un radiateur, une bouche de chaleur, un poêle ou autres (y compris les amplificateurs).
- 9 Ne modifiez pas les caractéristiques de la fiche avec mise à la terre polarisée. Une fiche polarisée est dotée de deux broches (l'une est plus large que l'autre). Une fiche avec mise à la terre comprend deux broches, ainsi qu'une troisième qui relie l'instrument à la terre. La broche la plus large (ou troisième broche) permet de sécuriser l'installation électrique. Si vous ne pouvez pas brancher le cordon d'alimentation dans la prise d'alimentation, demandez à un électricien de la remplacer.
- 10 Protégez le cordon d'alimentation. Cela permet d'éviter de marcher dessus ou de le tordre au niveau de la fiche, de la prise d'alimentation et des points de contact sur l'instrument.
- 11 N'employez que les dispositifs/accessoires indiqués par le fabricant.

- 12 Utilisez uniquement le chariot, le socle, le trépied, le support ou le plan indiqués par le fabricant ou livrés avec l'instrument. Si vous utilisez un chariot, soyez prudent si vous le déplacez avec l'instrument posé dessus pour éviter de le renverser.



- 13 Débranchez l'instrument en cas d'orage ou lorsque vous ne l'utilisez pas pendant des périodes prolongées.
- 14 Confiez toutes les réparations à des techniciens qualifiés. Des réparations sont nécessaires lorsque l'instrument est endommagé, notamment dans les cas suivants : cordon d'alimentation ou fiche défectueuse, liquides ou objets projetés sur l'appareil, exposition aux intempéries ou à l'humidité, fonctionnement anormal ou chute.

### AVERTISSEMENT

N'UTILISEZ PAS L'INSTRUMENT SOUS LA PLUIE OU DANS UN ENVIRONNEMENT HUMIDE, FAUTE DE QUOI VOUS RISQUEZ DE PROVOQUER UN INCENDIE OU DE VOUS ÉLECTROCUTER.

(UL60065\_03)

### Information for users on collection and disposal of old equipment:



This symbol on the products, packaging, and/or accompanying documents means that used electrical and electronic products should not be mixed with general household waste.

For proper treatment, recovery and recycling of old products, please take them to applicable collection points, in accordance with your national legislation.

By disposing of these products correctly, you will help to save valuable resources and prevent any potential negative effects on human health and the environment which could otherwise arise from inappropriate waste handling.

For more information about collection and recycling of old products, please contact your local municipality, your waste disposal service or the point of sale where you purchased the items.

#### For business users in the European Union:

If you wish to discard electrical and electronic equipment, please contact your dealer or supplier for further information.

#### Information on Disposal in other Countries outside the European Union:

This symbol is only valid in the European Union. If you wish to discard these items, please contact your local authorities or dealer and ask for the correct method of disposal.

(weee\_eu\_en\_02)

### Verbraucherinformation zur Sammlung und Entsorgung alter Elektrogeräte



Beindet sich dieses Symbol auf den Produkten, der Verpackung und/oder beiliegenden Unterlagen, so sollten benutzte elektrische Geräte nicht mit dem normalen Haushaltsabfall entsorgt werden.

In Übereinstimmung mit Ihren nationalen Bestimmungen bringen Sie alte Geräte bitte zur fachgerechten Entsorgung, Wiederaufbereitung und Wiederverwendung zu den entsprechenden Sammelstellen.

Durch die fachgerechte Entsorgung der Elektrogeräte helfen Sie, wertvolle Ressourcen zu schützen, und verhindern mögliche negative Auswirkungen auf die menschliche Gesundheit und die Umwelt, die andernfalls durch unsachgerechte Müllentsorgung auftreten könnten.

Für weitere Informationen zum Sammeln und Wiederaufbereiten alter Elektrogeräte kontaktieren Sie bitte Ihre örtliche Stadt- oder Gemeindeverwaltung, Ihren Abfallentsorgungsdienst oder die Verkaufsstelle der Artikel.

#### Information für geschäftliche Anwender in der Europäischen Union:

Wenn Sie Elektrogeräte ausrangieren möchten, kontaktieren Sie bitte Ihren Händler oder Zulieferer für weitere Informationen.

#### Entsorgungsinformation für Länder außerhalb der Europäischen Union:

Dieses Symbol gilt nur innerhalb der Europäischen Union. Wenn Sie solche Artikel ausrangieren möchten, kontaktieren Sie bitte Ihre örtlichen Behörden oder Ihren Händler und fragen Sie nach der sachgerechten Entsorgungsmethode.

(weee\_eu\_de\_02)

### Informations concernant la collecte et le traitement des déchets d'équipements électriques et électroniques



Le symbole sur les produits, l'emballage et/ou les documents joints signifie que les produits électriques ou électroniques usagés ne doivent pas être mélangés avec les déchets domestiques habituels.

Pour un traitement, une récupération et un recyclage appropriés des déchets d'équipements électriques et électroniques, veuillez les déposer aux points de collecte prévus à cet effet, conformément à la réglementation nationale.

En vous débarrassant correctement des déchets d'équipements électriques et électroniques, vous contribuerez à la sauvegarde de précieuses ressources et à la prévention de potentiels effets négatifs sur la santé humaine qui pourraient advenir lors d'un traitement inapproprié des déchets.

Pour plus d'informations à propos de la collecte et du recyclage des déchets d'équipements électriques et électroniques, veuillez contacter votre municipalité, votre service de traitement des déchets ou le point de vente où vous avez acheté les produits.

#### Pour les professionnels dans l'Union européenne :

Si vous souhaitez vous débarrasser des déchets d'équipements électriques et électroniques, veuillez contacter votre vendeur ou fournisseur pour plus d'informations.

#### Informations sur la mise au rebut dans d'autres pays en dehors de l'Union européenne :

Ce symbole est seulement valable dans l'Union européenne. Si vous souhaitez vous débarrasser de déchets d'équipements électriques et électroniques, veuillez contacter les autorités locales ou votre fournisseur et demander la méthode de traitement appropriée.

(weee\_eu\_fr\_02)

### Informações para os utilizadores relativas à recolha e eliminação de equipamentos usados



Este símbolo, presente em produtos, embalagens e/ou incluído na documentação associada, indica que os produtos elétricos e eletrônicos usados não devem ser eliminados juntamente com os resíduos domésticos em geral.

O procedimento correto consiste no tratamento, recuperação e reciclagem de produtos usados, pelo que deve proceder à respetiva entrega nos pontos de recolha adequados, em conformidade com a legislação nacional em vigor.

A eliminação destes produtos de forma adequada permite poupar recursos valiosos e evitar potenciais efeitos prejudiciais para a saúde pública e para o ambiente, associados ao processamento incorreto dos resíduos.

Para mais informações relativas à recolha e reciclagem de produtos usados, contacte as autoridades locais, o serviço de eliminação de resíduos ou o ponto de venda onde foram adquiridos os itens relevantes.

#### Informações para utilizadores empresariais na União Europeia:

Para proceder à eliminação de equipamento elétrico e eletrónico, contacte o seu revendedor ou fornecedor para obter informações adicionais.

#### Informações relativas à eliminação em países não pertencentes à União Europeia:

Este símbolo é válido exclusivamente na União Europeia. Caso pretenda eliminar este tipo de itens, contacte as autoridades locais ou o seu revendedor e informe-se acerca do procedimento correto para proceder à respetiva eliminação.

(weee\_eu\_pt\_02a)

# PRECAUTIONS

## PLEASE READ CAREFULLY BEFORE PROCEEDING

Please keep this manual in a safe and handy place for future reference.



### WARNING

Always follow the basic precautions listed below to avoid the possibility of serious injury or even death from electrical shock, short-circuiting, damages, fire or other hazards. These precautions include, but are not limited to, the following:

#### Power supply/Power cord

- Do not place the power cord near heat sources such as heaters or radiators. Also, do not excessively bend or otherwise damage the cord, or place heavy objects on it.
- Only use the voltage specified as correct for this product. The required voltage is printed on the name plate of this product.
- Use only the supplied power cord/plug.
- Check the electric plug periodically and remove any dirt or dust which may have accumulated on it.

#### Do not open

- This instrument contains no user-serviceable parts. Do not open this product or attempt to disassemble or modify the internal components in any way. If it should appear to be malfunctioning, discontinue use immediately and have it inspected by qualified Yamaha service personnel.

#### Water warning

- Do not expose this product to rain, use it near water or in damp or wet conditions, or place on it any containers (such as vases, bottles or glasses) containing liquids which might spill into any openings. If any liquid such as water seeps into this product, turn off the power immediately and unplug the power cord from the AC outlet. Then have this product inspected by qualified Yamaha service personnel.
- Never insert or remove an electric plug with wet hands.

#### Fire warning

- Do not put burning items, such as candles, on the unit. A burning item may fall over and cause a fire.

#### If you notice any abnormality

- When one of the following problems occur, immediately turn off the power switch and disconnect the electric plug from the outlet. Then have the device inspected by Yamaha service personnel.
  - The power cord or plug becomes frayed or damaged.
  - It emits unusual smells or smoke.
  - Some object has been dropped into this product.
  - There is a sudden loss of sound during use of this product.



### CAUTION

Always follow the basic precautions listed below to avoid the possibility of physical injury to you or others, or damage to this product or other property. These precautions include, but are not limited to, the following:

#### Power supply/Power cord

- Do not connect this product to an electrical outlet using a multiple-connector. Doing so can result in lower sound quality, or possibly cause overheating in the outlet.
- Do not use an AC outlet where the power plug fits loosely when inserted. Failure to observe this may cause a fire, electric shocks, or burns.
- Insert the power plug firmly all the way into the AC outlet. Using the unit when it is not plugged in sufficiently can cause dust to accumulate on the plug, causing a fire or burns.
- When removing the electric plug from this product or an outlet, always hold the plug itself and not the cord. Pulling by the cord can damage it.
- Remove the electric plug from the outlet when this product is not to be used for extended periods of time, or during electrical storms.

#### Assembly

- Read carefully the attached documentation explaining the assembly process. Failure to assemble this product in the proper sequence might result in damage to the instrument or even injury.
- Confirm that the finished installation is safe and secure. Also, carry out safety inspections periodically. Failure to observe this may cause devices to fall and result in injury.

#### Location

- Do not place this product in an unstable position where it might accidentally fall over.
- Do not place this product in a poorly ventilated place. Inadequate ventilation in the room may cause the speakers to overheat, possibly resulting in malfunction or fire.
- Before moving this product, remove all connected cables, to prevent damage to the cables or injury to anyone who might trip over them.
- When setting up the product, make sure that the AC outlet you are using is easily accessible. If some trouble or malfunction occurs, immediately turn off the power switch and disconnect the plug from the outlet. Even when the power switch is turned off, electricity is still flowing to the product at the minimum level. When you are not using the product for a long time, make sure to unplug the power cord from the wall AC outlet.
- Use only the rack specified for this product. When attaching the satellite speakers to the rack, use the provided pipe clamps only. Failure to do so could cause this product to fall over or fall off the rack onto the floor, or cause damage to this product or rack. For more information on the specified rack, see page 3.

## Connections

- Before connecting this product to the drum module, turn off the power for both this product and the drum module. Before turning the power on or off, set all volume levels to minimum.
- Be sure to set the volume levels of this product and the drum module to the minimum and gradually raise the volume controls while playing the drums to set the desired listening level.

## Handling caution

- Do not insert a finger or hand in any gaps on this product.
- Never insert or drop paper, metallic, or other objects into the gaps on the panel. This could cause physical injury to you or others, damage to this product or other property, or operational failure.
- Do not rest your weight on, or place heavy objects on this product, and do not use excessive force on the switches, knobs or connectors.
- Do not use this product for a long period of time at a high or uncomfortable volume level since this can cause permanent hearing loss or cause damage to this product. If you experience any hearing loss or ringing in the ears, consult a physician.

Yamaha cannot be held responsible for damage caused by improper use or modifications to this product, or data that is lost or destroyed.

Always turn the power off when this product is not in use.

Even when the [  ] (Standby/On) switch is in standby status (power lamp is off), electricity is still flowing to this product at the minimum level.

When you are not using this product for a long time, make sure you unplug the power cord from the wall AC outlet.

## NOTICE

To avoid the possibility of malfunction/ damage to the product, damage to data, or damage to other property, follow the notices below.

### ■ Handling

- Do not use this product in the vicinity of a TV, radio, stereo equipment, mobile phone, or other electric devices. Otherwise, the instrument, TV, or radio may generate noise.  
When you use a smart phone, tablet, or any other smart devices near this product, we recommend that you set Airplane Mode to “ON” on that device in order to avoid noise caused by communication.
- Do not expose this product to excessive dust or vibrations, or extreme cold or heat (such as in direct sunlight, near a heater, or in a car during the day) to prevent the possibility of panel disfiguration, damage to the internal components or unstable operation.
- Do not place vinyl, plastic or rubber objects on this product, since this might discolor the panel.

### ■ Maintenance

- When cleaning this product, use a soft cloth. Do not use paint thinners, solvents, alcohol, cleaning fluids, or chemical-impregnated wiping cloths.
- Gently remove dust and dirt with a soft cloth. Do not wipe too hard since small particles of dirt can scratch this product's finish.
- During extreme changes in temperature or humidity, condensation may occur and water may collect on the surface of this product. If water is left, the wooden parts may absorb the water and be damaged. Make sure to wipe any water off immediately with a soft cloth.

## Information

### ■ About this manual

- The illustrations as shown in this manual are for instructional purposes only, and may appear somewhat different from those on your speakers.
- The company names and product names in this manual are the trademarks or registered trademarks of their respective companies.

The model number, serial number, power requirements, etc., may be found on or near the name plate, which is at the rear of the unit. You should note this serial number in the space provided below and retain this manual as a permanent record of your purchase to aid identification in the event of theft.

**Model No.** \_\_\_\_\_

**Serial No.** \_\_\_\_\_

(rear\_en\_01)



Thank you for purchasing the Yamaha MS45DR Monitor Speaker system.  
Before using the speakers, we ask that you thoroughly read this Owner's Manual  
to use the product in a safe manner.

## Packing List

- Satellite speakers (2)

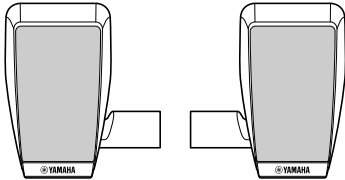

- Pipe clamps (2)



- Subwoofer speaker (1)

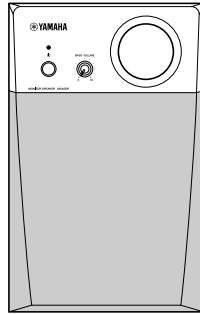

- Power cord (1)
- Owner's Manual (this document)

- 8-pin Mini DIN / Phone / RCA pin combination cable (1)

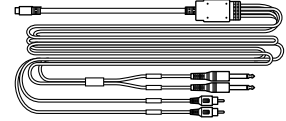

- Cable band (1)



To prevent cables from getting in the way of your performance, use the included cable band to secure cables where necessary. Be sure to set cables away from the pedals.

## Controls & Connectors

- Subwoofer speaker

[Front]

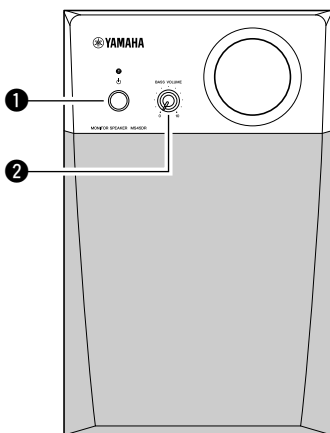

[Rear]

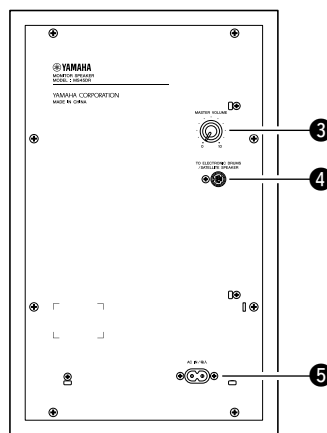

- 1 [⏻] (Standby/On) Switch

Switches Standby (■) power to off (indicator is off) or On (■) (indicator is on).

- 2 [BASS VOLUME] control

Use this control to adjust the volume of the subwoofer. Turn it clockwise to increase the volume and counterclockwise to decrease it.

- 3 [MASTER VOLUME]

This dial controls the master volume. Turn the dial clockwise to increase the volume or counter-clockwise to decrease it.

- 4 [TO DRUM MODULE / SATELLITE SP] jack

This jack is used to connect the subwoofer speaker to the satellite speakers and the drum module.

- 5 [AC IN] jack

Connect the included power cord to this connector.

● **Satellite speaker**

[Rear]

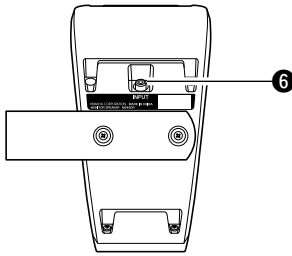

⑥ **[INPUT] jack**

This jack is used to connect the satellite speaker to the subwoofer.

## Installing the Monitor Speakers

**⚠ CAUTION**

The MS45DR satellite speakers can be attached to straight vertical pipes of 1.5-inch (38.1-mm) diameter. These speakers cannot be attached to curved pipes or any pipes of different diameter sizes.

1. First insert the speaker mount of the satellite speaker into the hole ① of the pipe clamp, then tighten the wing bolt.

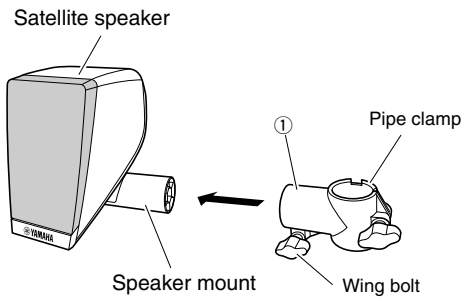

2. As shown in Figure A, slowly insert one leg of your drum rack through the hole ② of the pipe clamp. When you finish adjusting the position, tighten the wing bolt as shown in Figure B.

**⚠ CAUTION**

Be sure to attach the satellite speakers to the leg of the drum rack slowly and deliberately to avoid injury.

**NOTE** Be sure to tighten the wing bolts securely.

[Figure A]

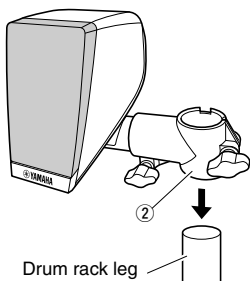

[Figure B]

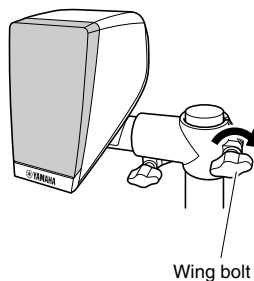

3. See Figure C. Place the Subwoofer speaker on a flat floor.
4. Connect the satellite speakers, subwoofer speaker, and the drum module via the included combination cable as shown in Figure C.

**⚠ WARNING**

Use only the supplied power cord.

**⚠ CAUTION**

When setting up the product, make sure that the AC outlet you are using is easily accessible. If some trouble or malfunction occurs, immediately turn off the power switch and disconnect the plug from the outlet.

[Figure C]

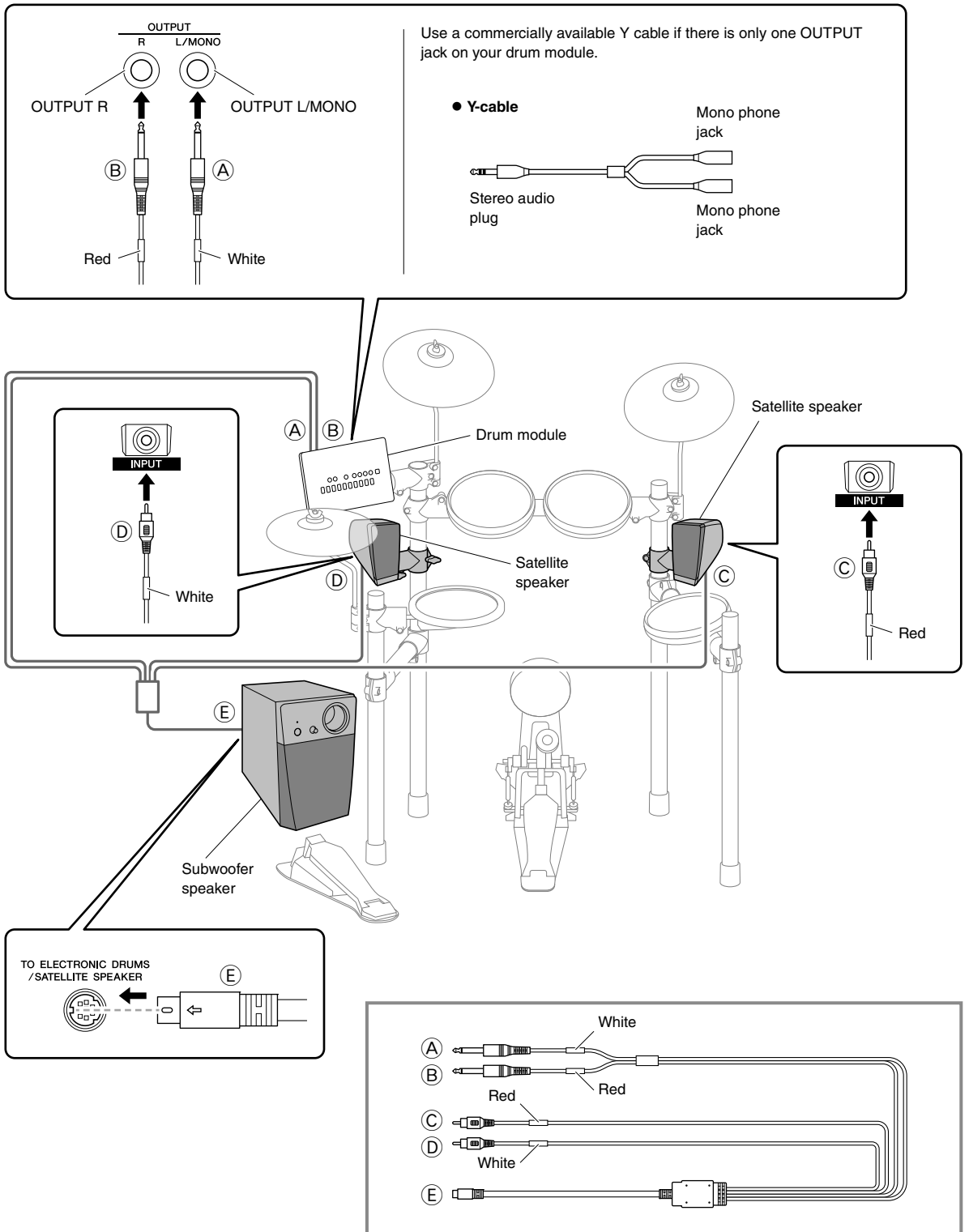

\* The red RCA connector is for the right channel, and the white RCA connector is for the left channel.

## Examples of other setups

The satellite speakers can be attached to other pipes on the drum rack, as in the examples shown below.

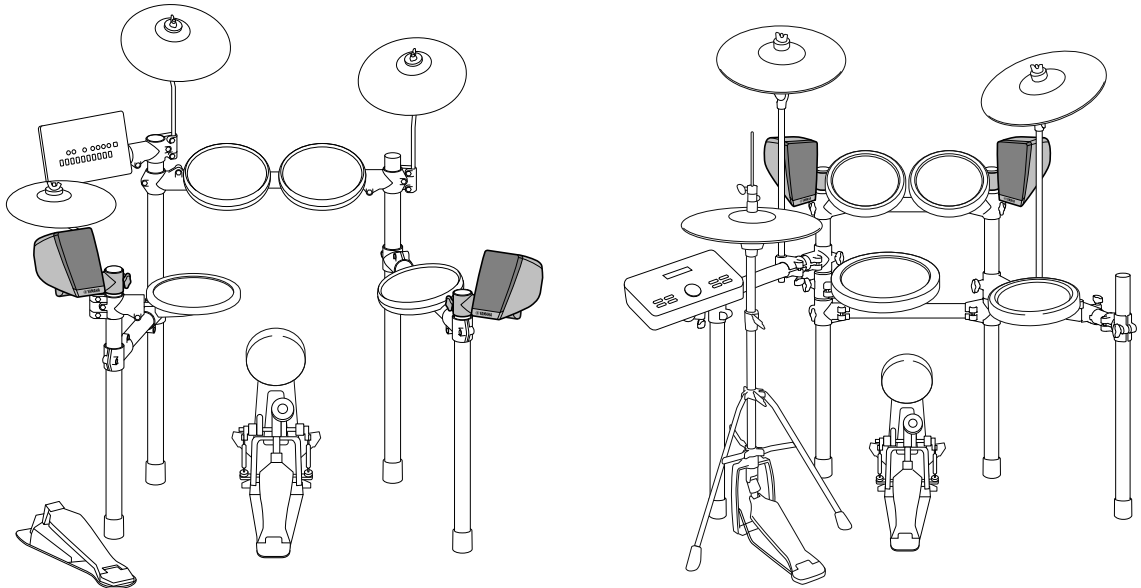

5. Connect the power cord to the [AC IN] jack on the subwoofer.
6. Plug the power cord into an AC wall socket or another electrical outlet.

**NOTE** Follow the order shown above in reverse when disconnecting the power cord.

## Turning the power on or off

### ⚠ CAUTION

Even when the power switch is turned off, electricity is still flowing to the product at the minimum level. When you are not using the product for a long time, make sure to unplug the power cord from the wall AC outlet.



### Turning the power on

1. Lower the volume with the [MAIN VOLUME] control on the subwoofer speaker and the volume control on your drum module to the minimum.
2. Press the [⏻](Standby/On) switch on the subwoofer speaker to turn the power on.
3. Turn on your drum module.
4. Adjust the volume with the [MAIN VOLUME] control on the subwoofer speaker and the volume control on your drum module while playing the pads.

### Tuning the power off

1. Lower the volume with the [MAIN VOLUME] control on the subwoofer speaker and the volume control on your drum module to the minimum.
2. Press the [⏻](Standby/On) switch on the subwoofer speaker to turn the power off.
3. Turn off your drum module.

## Troubleshooting

No sound comes from the satellite speakers or subwoofer.	The power cord is not properly plugged into the wall outlet.	Insert the power cord firmly into the wall outlet.
	The [  ](Standby/On) Switch on the subwoofer is set to OFF.	Set the [  ](Standby/On) Switch to ON.
	Connections are faulty or incomplete.	<ul style="list-style-type: none"> <li>• Make sure the connections are secure.</li> <li>• Make sure to use the included power cord.</li> </ul>
	The volume is set too low.	<ul style="list-style-type: none"> <li>• Turn the [MASTER VOLUME] clockwise to increase the volume.</li> <li>• Turn the subwoofer [BASS VOLUME] control clockwise to increase the volume.</li> <li>• Raise the volume on your drum module.</li> </ul>
Sound is distorted.	The volume is set too high.	<ul style="list-style-type: none"> <li>• Turn the [MASTER VOLUME] counterclockwise to decrease the volume.</li> <li>• Turn the subwoofer [BASS VOLUME] control counterclockwise to decrease the volume.</li> <li>• Lower the volume on your drum module.</li> </ul>
	The levels of the low frequency ranges in the Master EQ settings of your drum module are set too high.	Lower the Master EQ settings of your drum module. For details, refer to the Owner's Manual that came with your drum module.
Sound is interrupted.	The level of the signal being input is too high.	Turn down the volume on the instrument and/or the subwoofer speaker.
Noise occurs in the sound.	Connections are faulty or incomplete.	<ul style="list-style-type: none"> <li>• Make sure the connections are secure.</li> <li>• Make sure to use the included power cord.</li> </ul>
The speakers produce a "pop" sound whenever the power is turned ON or OFF.	The subwoofer is turned on before the drum module is turned on.	First turn on the drum module, and then turn on the subwoofer.

## Specifications

<b>Output power</b>	Satellite speakers	20 W + 20 W (2 kHz, 4 Ω)
	Subwoofer	20 W (60 Hz, 8 Ω)
<b>Frequency response</b>	Satellite speakers / Subwoofer speaker	40–20000 Hz (-10 dB)
<b>Speaker unit</b>	Satellite speakers	Tweeter: 2 cm (0.8") dome (5 Ω) Midrange: 8 cm (3") cone (4.5 Ω)
	Subwoofer	16 cm (6.5") cone (8 Ω)
<b>Dimensions (W x H x D)</b>	Satellite speakers	110 × 183 × 138 mm (4 5/16" × 7 3/16" × 5 7/16" ) not including holder
	Subwoofer	221 × 351 × 343 mm (8 11/16" × 13 13/16" × 13 1/2")
<b>Weight</b>	Satellite speakers	1.0 kg (2 lb, 3 oz) × 2
	Subwoofer	6.5 kg (14 lb, 5 oz)
<b>Accessories</b>	Pipe clamps* (2), combination cable (8 pin mini DIN to phone and RCA pin) (1), cable band (1), power cord (1), Owner's Manual (this document) (1) * Can be attached to straight vertical pipes of 1.5-inch (38.1-mm) diameter.	

\* The contents of this manual apply to the latest specifications as of the publishing date. To obtain the latest manual, access the Yamaha website then download the manual file. Since specifications, equipment or separately sold accessories may not be the same in every locale, please check with your Yamaha dealer.

MEMO



VCA3720

Yamaha Global Site  
<https://www.yamaha.com/>  
Yamaha Downloads  
<http://download.yamaha.com/>

Manual Development Group  
© 2019 Yamaha Corporation  
Published 01/2019  
2019年1月 发行  
PO-A0

VCA3720